

CONSTRUCTION & MAINTENANCE PATTERNS & COSTS.

MOD. TECH.
Years → 0

(NPV)

5

10

15

20

25

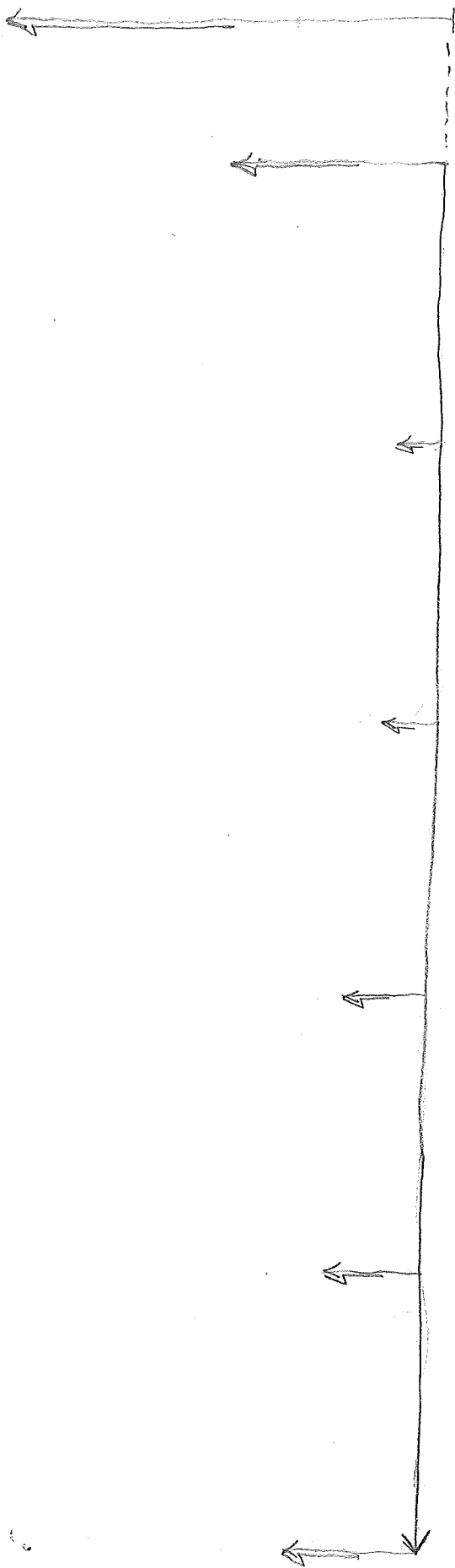

TRAD. TECH

(NPV)

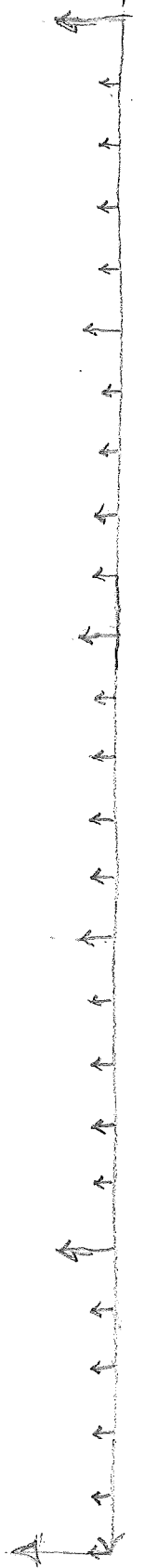

↓ Local Resource Use.
↑ External " "

1.1 CONSTRUCTION EXPENDITURES. DISTRIBUTION OF BUILDING CONSTRUCTION EXPENDITURES. (Amongst inputs, spatially/social groups)

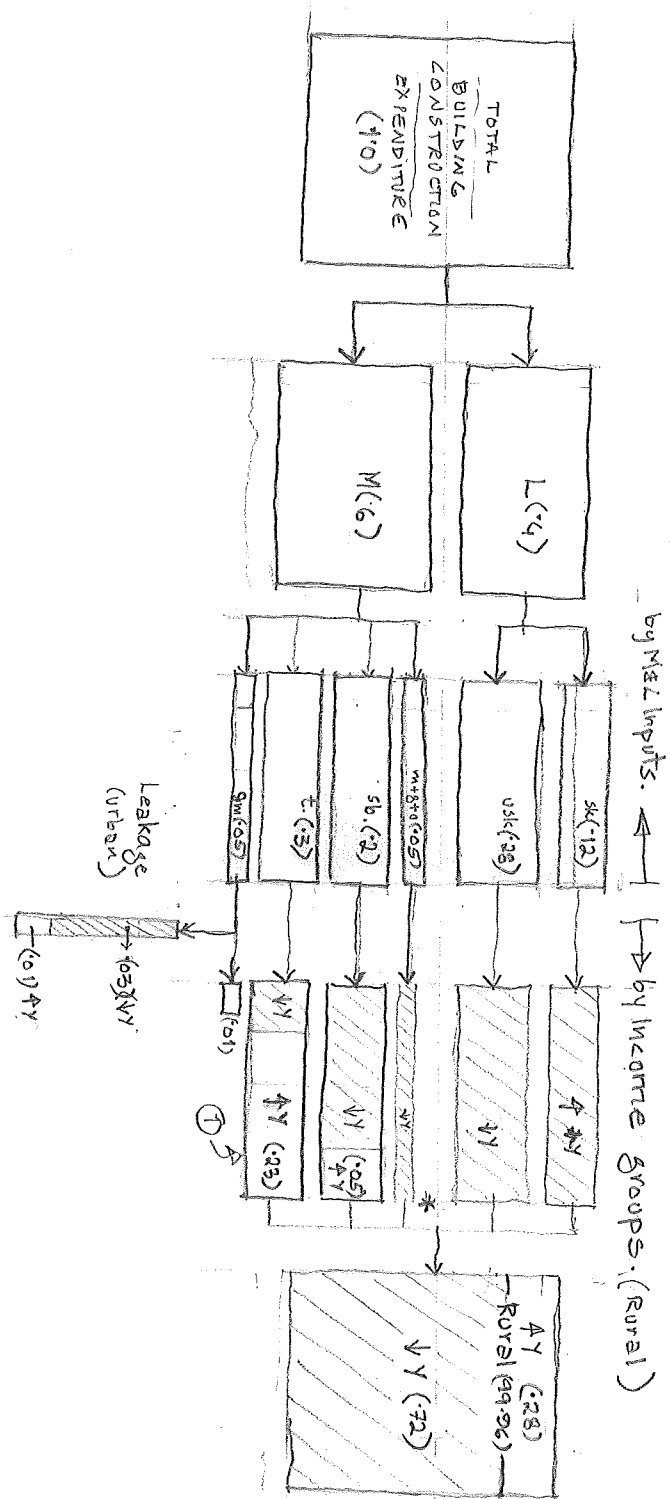

1.2. INCOME MULTIPLIERS (Inv responding)

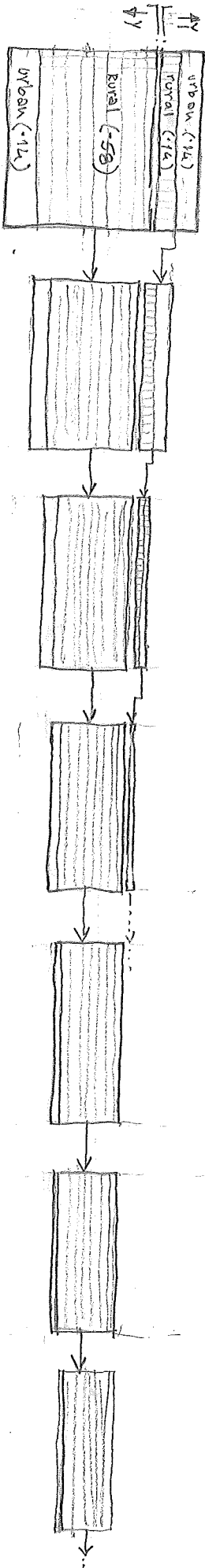

* Are mult. costs = to income generated from workers. (Yes, to extent all inputs for each unit also be fixed for inv.?)
 1st round income effects: on-site employment. 2nd round effects: 'S' in workers. inv. 3rd round: 'S' thru inputs into work. inv. etc.

DISTRIBUTION OF BLDNG. CONSTRUCTION EXPENDITURES (amongst inputs, rural-urban & income groups)

2.0 MODERN BLDNG. TECH.

2.1. CONSTRUCTION EXPENDITURES: by L&M inputs.

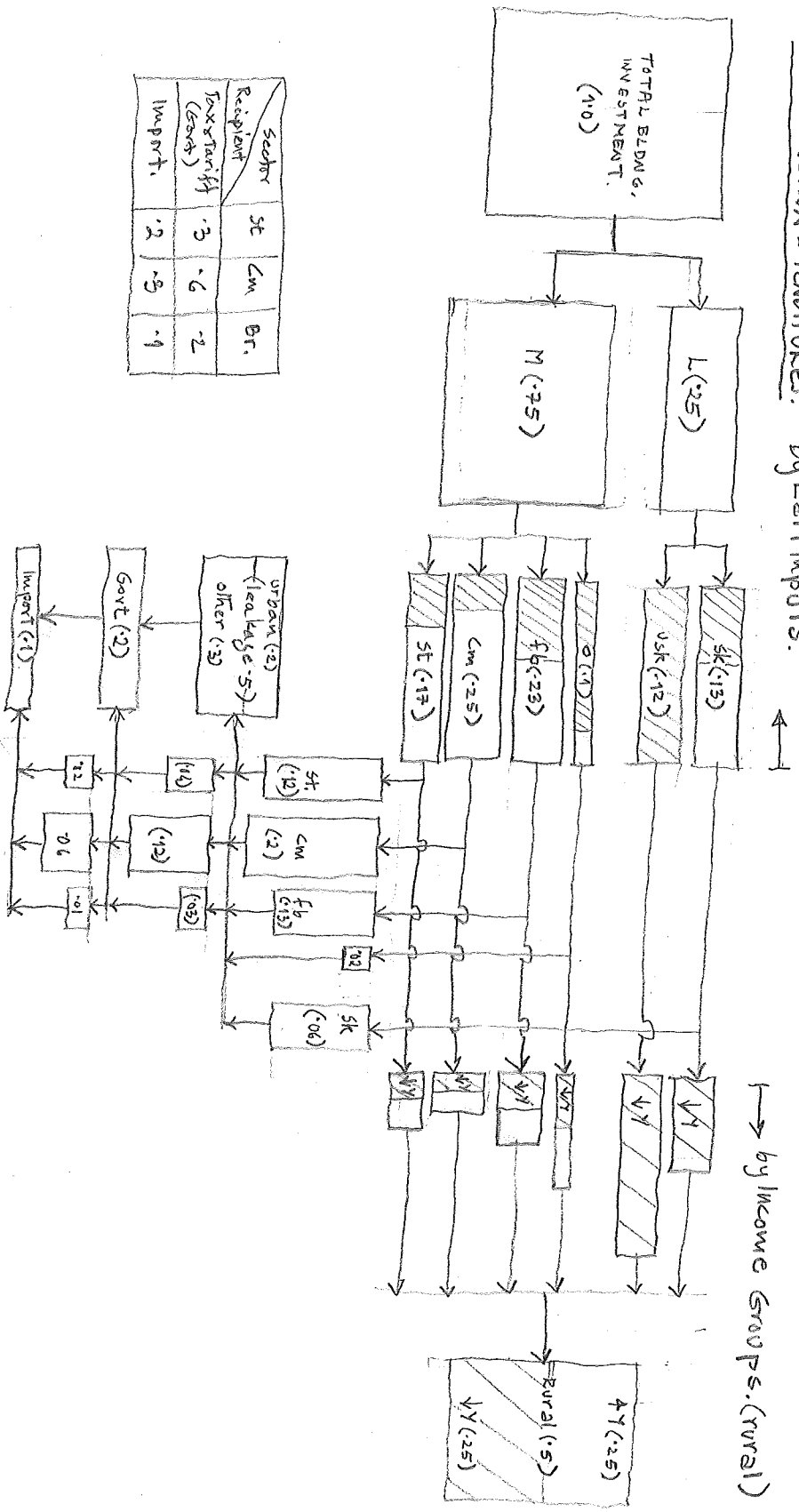

Sector	St	CM	BR.
Recipient			
Tax & Tariff (Govt)	.3	.6	.2
Import.	.2	.5	.1

2.2. INCOME MULTIPLIERS (TRV responding)

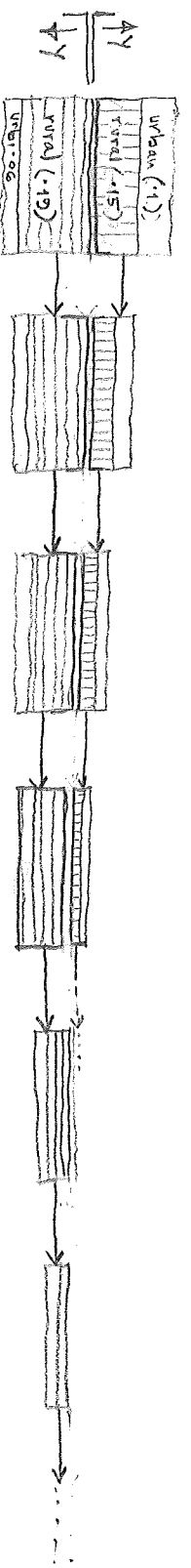

THE EFFECT OF BUILDING INVESTMENT ON OUTPUT & EMPLOYMENT:

1. Under Existing Technology Adoption Patterns.

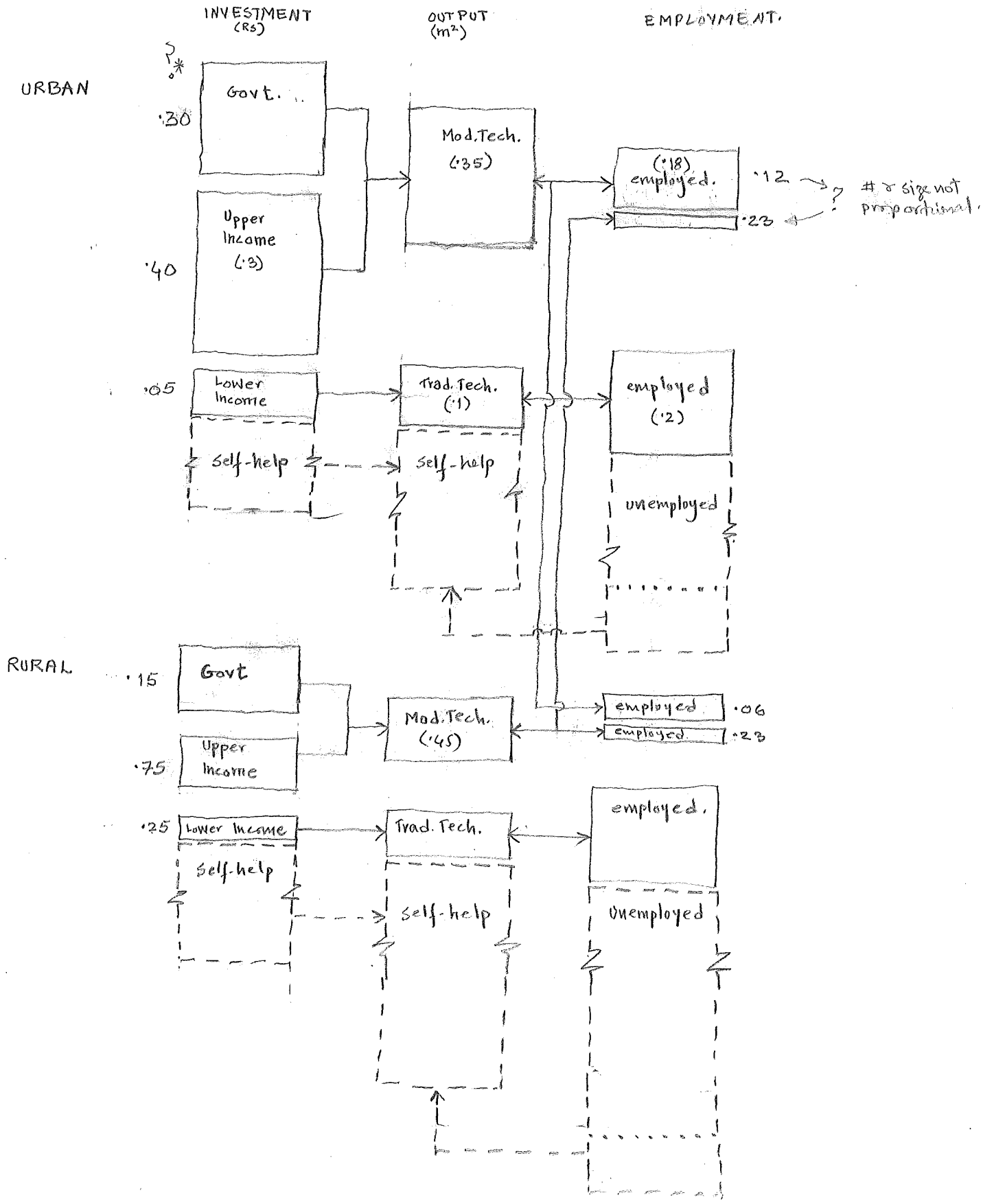

2. Switching to an (Upgraded) Traditional Technology.

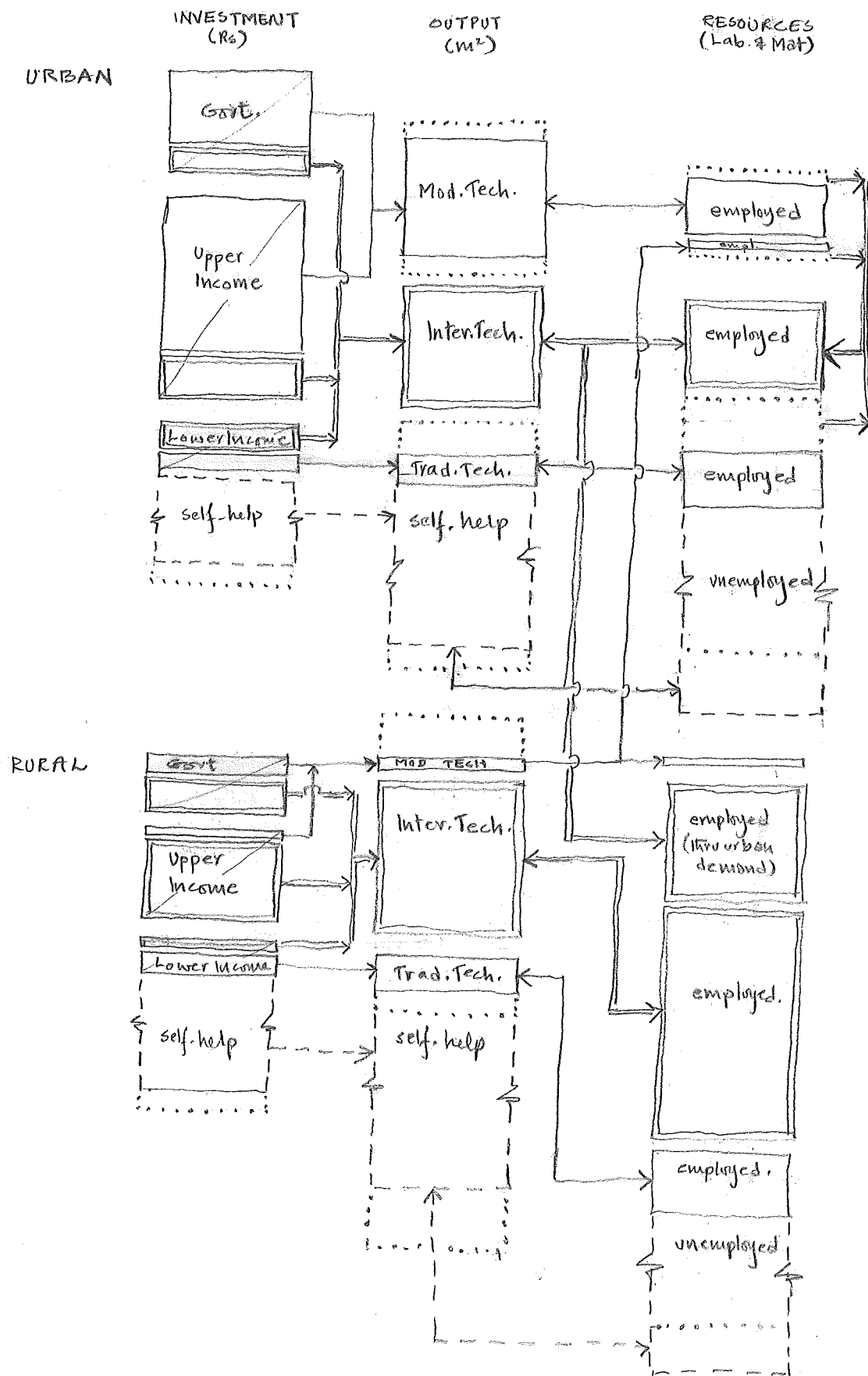

can estimate R's X' switch from mod. to inter. in 2 ways. 1) From ^{from gov't. & DP} estimating proportions of bl by types that can be constructed using inter. tech. instead 2) Assigning 'ages' if X% upper 'Y' shift of it will be so & so. if 1/2.. ^{mod'}